

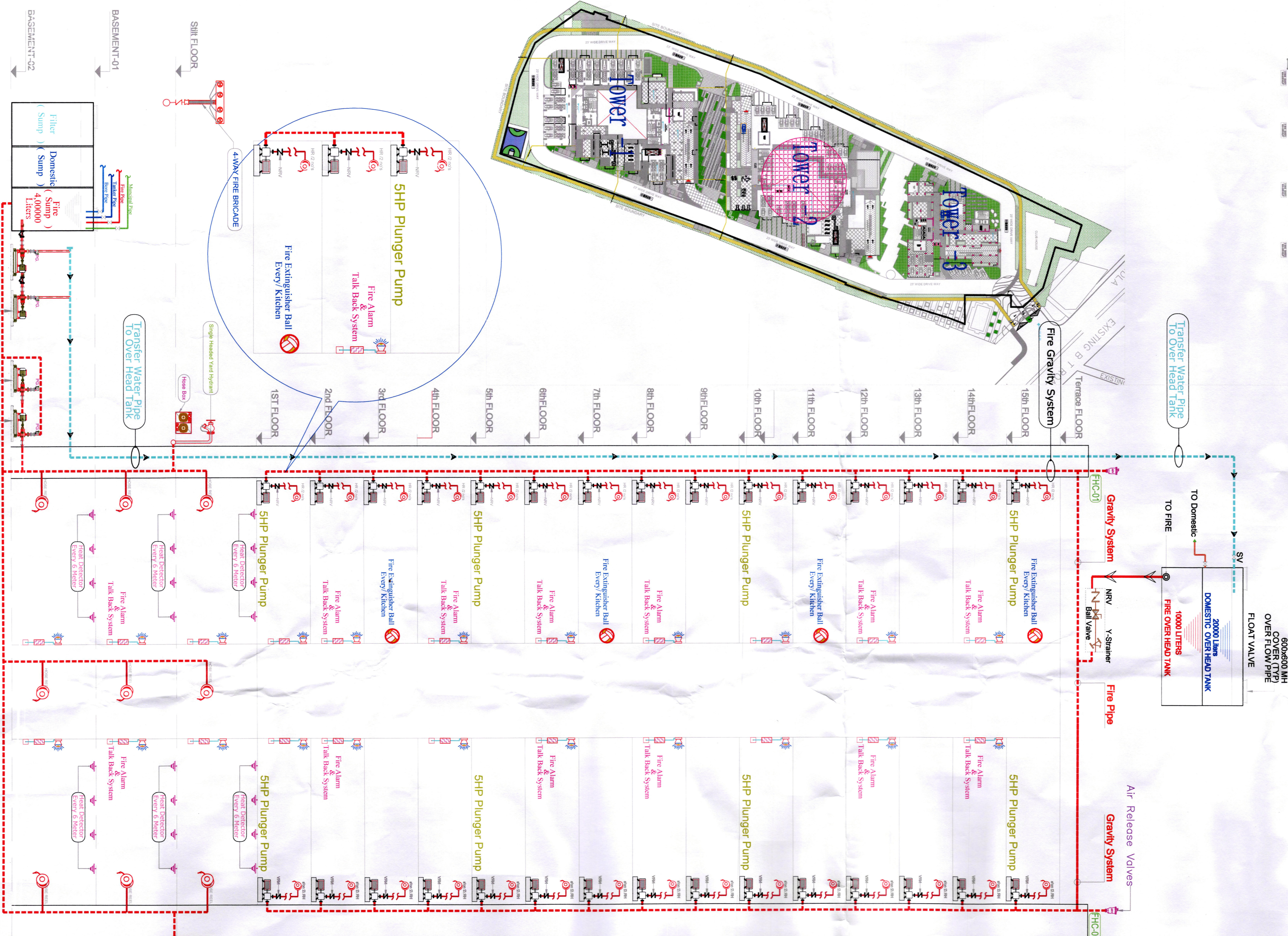

SNO	LEGEND
01	Every 2 Floor By- Pass Connection with standby Motors for the redundancy
02	Each Floor 2no's 5hp Plunger Pump
03	Stilt Floor 1no's 10hp Mobile Plunger Pump
04	B1 Floor 1no's 10hp Mobile Plunger Pump
04	B2 Floor 1no's 10hp Mobile Plunger Pump
	TERRACE OVER HEAD FIRE TANK 10000 Liters Each Tower

NO	NOTES
1	All electrical panel Equipped With Co2 Gas Suppression system/ Flooding
2	All Parking Floors With Heat Sensor connected to Fire Alarm Panel
3	All Residential Floors With Fire Alarm System Connected to Fire Alarm Panel
4	All Pumps Connected to EB Power And Stand By DG Power Back Up
5	Domestic LPG Cylinder To be Placed out side the Kitchen ,Placed in the utility For Kitchen Safety.
6	Each Apartment provided With (E/LCB) & Earthing.
7	Building lightning Protection System Followed As Per NBC 2016 Electrical Norms
8	EV Car charging consider for parking Co2 Extinguisher provided
9	Parking Heat Detection system provided with fire Alarm Panel integration system.
10	All typical flat kitchen Area provided with self Fire Ball Extinguisher.
11	Mobile Foam Suppression System of 100 kg is provided in Each Fire zone.



Tower-2 FIRE FIGHTING SCHEMATIC

Director General
State Disaster Response, & Fire Services
Andhra Pradesh, Vijayawada

TEAMONE INDIA PVT.LTD
1001, 1002, 1003, 1004, 1005, 1006, 1007, 1008, 1009, 1010, 1011, 1012, 1013, 1014, 1015, 1016, 1017, 1018, 1019, 1020, 1021, 1022, 1023, 1024, 1025, 1026, 1027, 1028, 1029, 1030, 1031, 1032, 1033, 1034, 1035, 1036, 1037, 1038, 1039, 1040, 1041, 1042, 1043, 1044, 1045, 1046, 1047, 1048, 1049, 1050, 1051, 1052, 1053, 1054, 1055, 1056, 1057, 1058, 1059, 1060, 1061, 1062, 1063, 1064, 1065, 1066, 1067, 1068, 1069, 1070, 1071, 1072, 1073, 1074, 1075, 1076, 1077, 1078, 1079, 1080, 1081, 1082, 1083, 1084, 1085, 1086, 1087, 1088, 1089, 1090, 1091, 1092, 1093, 1094, 1095, 1096, 1097, 1098, 1099, 1100

TEAMONE INDIA PVT.LTD
1001, 1002, 1003, 1004, 1005, 1006, 1007, 1008, 1009, 1010, 1011, 1012, 1013, 1014, 1015, 1016, 1017, 1018, 1019, 1020, 1021, 1022, 1023, 1024, 1025, 1026, 1027, 1028, 1029, 1030, 1031, 1032, 1033, 1034, 1035, 1036, 1037, 1038, 1039, 1040, 1041, 1042, 1043, 1044, 1045, 1046, 1047, 1048, 1049, 1050, 1051, 1052, 1053, 1054, 1055, 1056, 1057, 1058, 1059, 1060, 1061, 1062, 1063, 1064, 1065, 1066, 1067, 1068, 1069, 1070, 1071, 1072, 1073, 1074, 1075, 1076, 1077, 1078, 1079, 1080, 1081, 1082, 1083, 1084, 1085, 1086, 1087, 1088, 1089, 1090, 1091, 1092, 1093, 1094, 1095, 1096, 1097, 1098, 1099, 1100

TITLE :
PLAN SHOWING THE PROPOSED RESIDENTIAL APARTMENT IN SURVEY NO.82, 87/A/1/C, SITUATED AT WARD NO. 18, GUNTUR MANDAL, GUNTUR DISTRICT, BELONGING TO:
DEVELOPED BY
BARANG URBAN INFRA PVT.LTD.
ELURU JUTE MILLS PVT.LTD.
REPRESENTED BY ITS MANAGING DIRECTOR
SRI. SIDDHENTI SRINIVASA RAO
S/o SIDDHENTI RATNARAO

AREA STATEMENT
SITE AREA : 21,367.86 Sqmts (or) 25,555.74 Sqyds (5.28 Acres)
ROAD WIDENING AREA : 134.12 Sqmts
NET SITE AREA : 21,233.74 Sqmts (5.24 Acres)

TOTAL BUILT-UP AREA
2nd BASEMENT FLOOR PARKING AREA : 18,360.86 Sqmts
REQUIRED VENTILATION AREA (250%) : 459.02 Sqmts
PROPOSED VENTILATION AREA (294%) : 539.83 Sqmts
TOTAL NO. OF CARS IN BASEMENT-1 : 331 NO.S

SPECIFICATIONS
FOUNDATION : R.C.C. M 30 GRADE
COLUMNS : R.C.C. M 30 GRADE
WALLS BEAMS & SOLID BLOCKS : R.C.C. M 30 GRADE
CHALUS : R.C.C. M 30 GRADE
DOORS/WINDOWS, & VENTILATORS : Teak/Wood
FLOORING : Ceramic Tiles
PLASTERING : C.M.

UNDER GROUND/SWP PERCOLATION PIT ELECTRICAL LINE MAIN HOLE ELECTRICAL TRANSFORMER SEWAGE TREATMENT PLANT

REFERENCE:-
PROPOSED EXISTING DEMOLISHED

ALL DIMENSIONS ARE IN METERS

SCALE : 1 : 100

OWNERS SIGNATURE

BUILDERS SIGNATURE

STRUCTURAL ENGINEERS SIGNATURE

ARCHITECTS SIGNATURE

TEAMONE INDIA PVT.LTD
1001, 1002, 1003, 1004, 1005, 1006, 1007, 1008, 1009, 1010, 1011, 1012, 1013, 1014, 1015, 1016, 1017, 1018, 1019, 1020, 1021, 1022, 1023, 1024, 1025, 1026, 1027, 1028, 1029, 1030, 1031, 1032, 1033, 1034, 1035, 1036, 1037, 1038, 1039, 1040, 1041, 1042, 1043, 1044, 1045, 1046, 1047, 1048, 1049, 1050, 1051, 1052, 1053, 1054, 1055, 1056, 1057, 1058, 1059, 1060, 1061, 1062, 1063, 1064, 1065, 1066, 1067, 1068, 1069, 1070, 1071, 1072, 1073, 1074, 1075, 1076, 1077, 1078, 1079, 1080, 1081, 1082, 1083, 1084, 1085, 1086, 1087, 1088, 1089, 1090, 1091, 1092, 1093, 1094, 1095, 1096, 1097, 1098, 1099, 1100